



31/42 Hoxton Park Road Liverpool NSW

2  2  1 

Only 3 years young this Luxurious apartment on the top level provides a spacious practical floor plan. Situated only moments away to Liverpool CBD, Liverpool Train station, Woodward park and amenities the location applies convenience and a relaxed lifestyle.

The Apartment provides a open plan living filled with natural light and unobstructed views of the Liverpool CBD from the large balcony.

Appointing quality fixtures and finishes throughout this apartment will not disappoint the savvy investor, first home purchaser or downsizer.

Highlight features:

Price : \$ 448,000

View : <https://www.assetpropertyagents.com.au/sale/nsw/liverpool-fairfield/liverpool/residential/apartments/5676950>



Sam Nahlous
(02)87100338

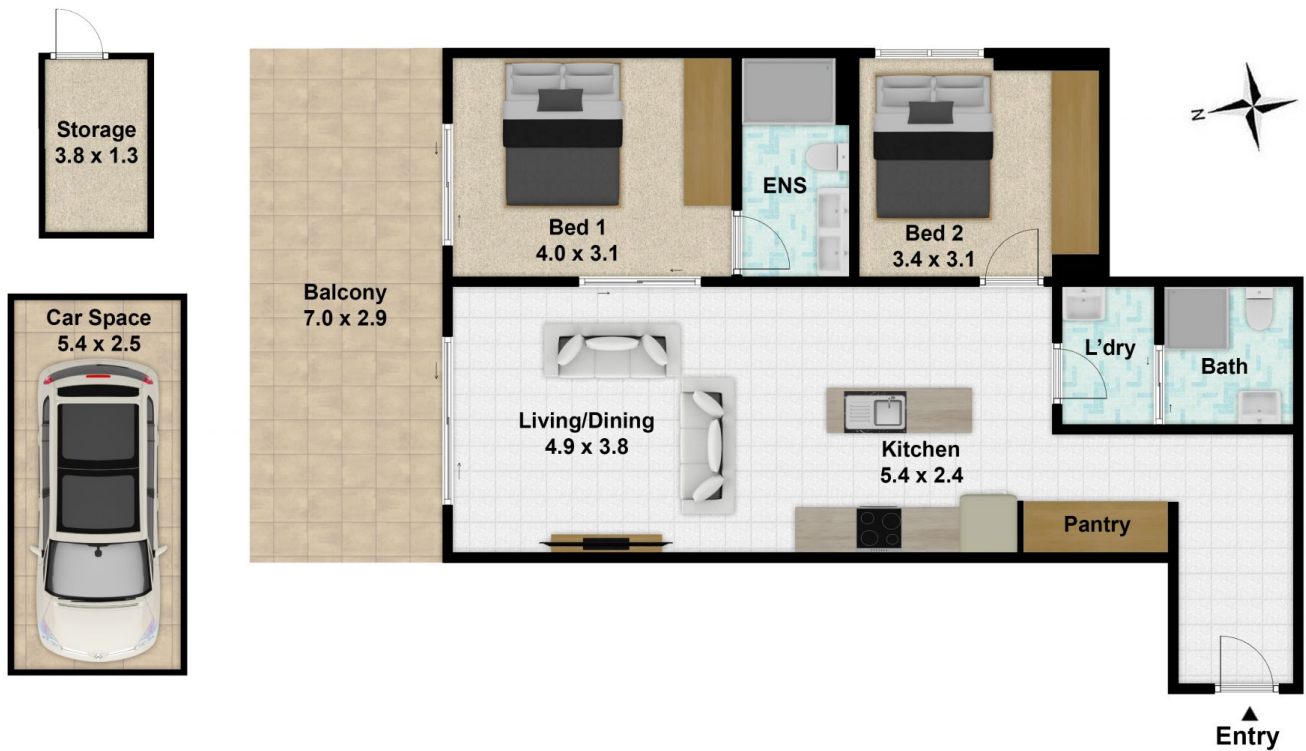

31/42 Hoxton Park Road, Liverpool NSW 2170

DISCLAIMER: THIS IS FOR ILLUSTRATIVE PURPOSES ONLY. ALL DIMENSIONS ARE APPROXIMATE AND IT DO NOT CONSTITUTE PART OF ANY LEGAL DOCUMENT.
All dimensions are approximate. Actual dimensions may vary. Floor plan prepared by realestatephotographs.com.au 0401957996